

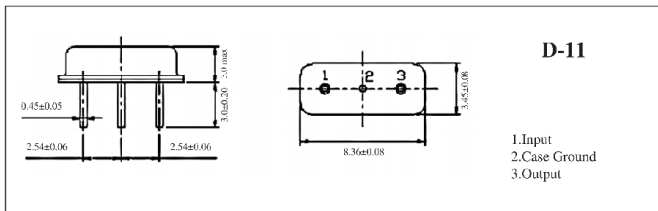

电气参数 ELECTRICAL SPECIFICATIONS

项次 Item	规格 Specification		
	TO39	F11	D11
频率范围 Frequency Range(MHz)	224.500~915.00	224.500~915.00	224.500~915.00
调整频差 Frequency Tolerance (at 25°C)	±75KHz Standard, (±150KHz, ±50KHz Available)		
直流电压 DC Voltage VDC	10V		
交流电压 AC Voltage Vpp	10V 50Hz / 60Hz		
工作温度 Operating Temperature Range	-40°C~+85°C		
储存温度 Storage Temperature Range	-55°C~+125°C		
插入损耗 Insertion Loss (dB)	2.5		
绝缘电阻 DC. Insulation Resistance	1MΩ		
静态电容 Shunt Capacitance	< 2.8 PF		
老化率 Aging (at 25°C)	10ppm/year Max		
回流焊条件 Reflow Conditions	260°C for 5s Max, 2 reflows Max		

外形尺寸 DIMENSIONS(mm)

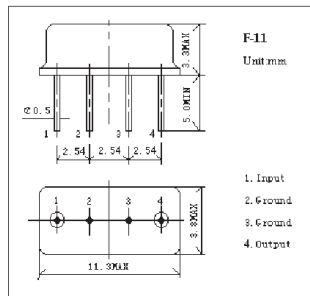
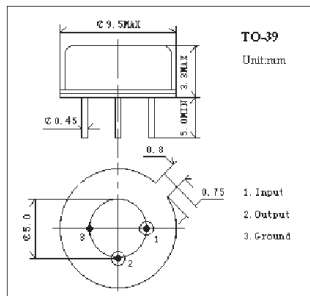

回流焊曲线 SODLE REFLOW PROFILE

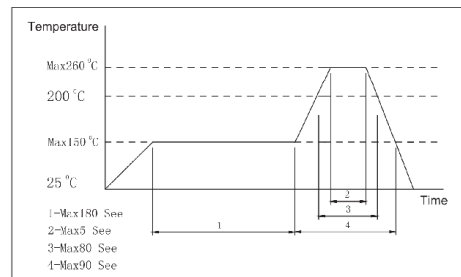

主要参数除以上指标外, 可根据用户要求制作特殊规格的产品
Mostly parameter out above guideline, can produce special specifications products according to your requirement.