



## 电气参数 ELECTRICAL SPECIFICATIONS

项次 Item	规格 Specification		
	49S-SMD-2PIN	49S-SMD-3PIN	49SS-SMD-2PIN
频率范围 Frequency Range(MHz)	3.200~70.000	3.200~70.000	3.200~70.000
振荡模式 Mode of Oscillation	基频 Fundamental(三次泛音 3rd)		
调整频差 Frequency Tolerance (at 25°C)	±20ppm Standard, (±5ppm, ±10ppm, ±30ppm Available)		
温度频差 Frequency Stability Over Temperature	±20ppm Standard, (±10ppm, ±30ppm Available)		
工作温度 Operating Temperature Range	-20°C~+70°C Standard, -40°C~+85°C Extended		
储存温度 Storage Temperature Range	-40°C~+120°C		
老化率 Aging (at 25°C)	±3ppm/year Max		
负载电容 Load Capacitance	8PF~32PF or Series		
静态电容 Shunt Capacitance	4.0PF Max		
驱动功率 Drive Level	0.01μw~100μw		
回流焊条件 Reflow Conditions	260°C for 5s Max, 2 reflows Max		

## 等效电阻 Equivalent Series Resistance

频段	型号	HC-49S-DIP2	HC-49S-DIP3	HC-49SS-DIP2
3.2MHz ≤ Freq. < 3.5MHz		120~100Ω	120~100Ω	120~100Ω
3.5MHz ≤ Freq. < 5.0MHz		100~80Ω	100~80Ω	100~80Ω
5.0MHz ≤ Freq. < 8.0MHz		80~60Ω	80~60Ω	80~60Ω
8.0MHz ≤ Freq. < 12MHz		60~30Ω	60~30Ω	60~30Ω
12MHz ≤ Freq. < 40MHz		30~25Ω	30~25Ω	30~25Ω
30MHz ≤ Freq. < 70MHz 3RD		80~60Ω	80~60Ω	80~60Ω

## 外形尺寸 DIMENSIONS(mm)

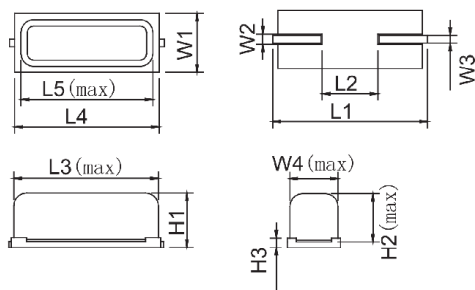

型号	外形尺寸(mm)											
	L1	L2	L3	L4	L5	W1	W2	W3	W4	H1	H2	H3
HC-49S-SMD2	12.5	4.4	10.2	11.4	11.0	4.7	1.1	0.85	3.8	4.0	3.8	0.8
HC-49S-SMD3	12.5	4.4	10.2	11.4	11.0	4.7	1.1	0.85	3.8	4.0	3.8	0.8
HC-49SS-SMD2	12.5	4.4	10.2	11.4	11.0	4.7	1.1	0.85	3.8	3.0	2.8	0.65

## 回流焊曲线 SODLE REFLOW PROFILE

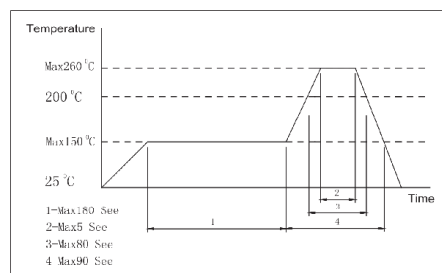

主要参数除以上指标外, 可根据用户要求制作特殊规格的产品  
Mostly parameter out above guideline, can produce special specifications products according to your requirement.