

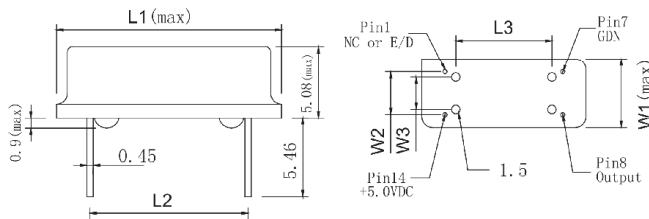

电气参数 ELECTRICAL SPECIFICATIONS

项次 Item		规格 Specification	
参数 Parameter		3.3V	5.0V
供给电压 Supply Voltage		3.3V±10%	5.0V±10%
频率范围 Frequency Range		250KHz~150.0MHz	
频率稳定性 Frequency Stability		±20ppm(Standard)at 25°C±3°C, ±10ppm~±100ppm available	
供给电流 Supply Current	0.500~23.999 MHz	15mA Max	20mA Max
	24.000~44.999 MHz	20mA Max	30mA Max
	50.000~69.999 MHz	30mA Max	40mA Max
	70.000~150.000MHz	45mA Max	60mA Max
工作温度 Operating Temperature		-20°C~+70°C Standard, -40°C~+85°C Available	
储存温度 Storage Temperature		-55°C~+125°C	
占空比 Duty Cycle		40%~60%	
输出电压高 Output High (Logic "1")		90VDD% Min	
输出电压低 Output Low (Logic "0")		10VDD% Max	
启动时间 Start Time		< 10ms	
待机电流 Standby Current		< 15µA	
老化率 Aging (at 25±3°C)		±3ppm/year Max	

外形尺寸 DIMENSIONS(mm)



型号	外形尺寸(±0.15mm)					
	L1	L2	L3	W1	W2	W3
振荡器-PIN14-DIP	20.8	15.24	12.10	13.08	7.62	4.53
振荡器-PIN8-DIP	13.08	7.62	7.62	13.08	7.62	4.53

回流焊曲线 SODLE REFLOW PROFILE

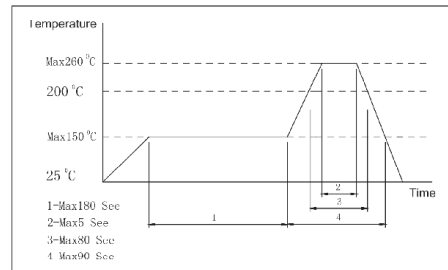

主要参数除以上指标外, 可根据用户要求制作特殊规格的产品
Mostly parameter out above guideline, can produce special specifications products according to your requirement.